



## COMPRESSED AIR HORN

# LINE TR/MAX 24V

**E3** 28

### Technical drawing

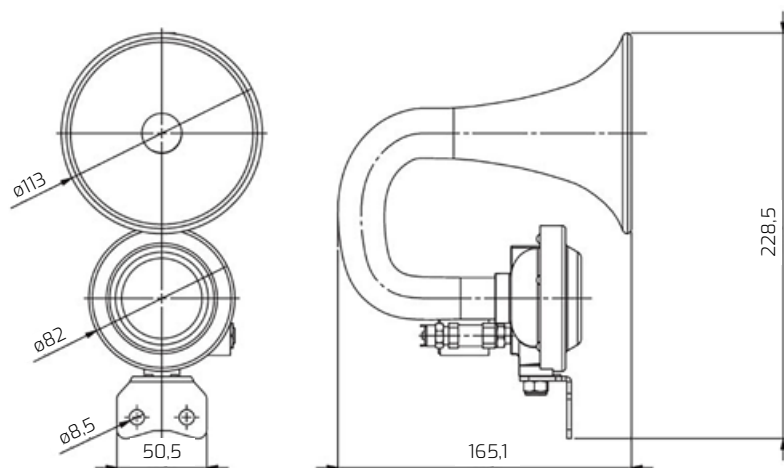

### Connection

2 plugs 6,3 x 0,8 mm

# LINE TR/MAX 24V

## Technical features

Nominal Voltage	Vcc	24
Voltage Range	Vcc	22,8÷27,6
Current Consumption	A	<0,5
Operating pressure	kPa	600 ÷ 1200
Air consumption at 850 Kpa	NL/1 min	<350
Sound Pressure Level (at 2 meters)	dB(A)	117
Fundamental frequency	Hz	400
Durability (1" On + 4" Off )	cycles	>500.000
Corrosion resistance (UNI 9227)	h	>500
Operating and Storage Temperature	°C	from -30 to +80
Vibrations (30 min x 3 axis)	g	1
Weight with screws	gr	600

## Packing

Single Packing Dimensions	mm	215 x 150 x 120 h
Master Carton Quantity	pcs	10
Master Carton Dimensions	cm	52 x 38 x 26 h
Master Carton Weight	kg	7

## Mounting Instructions

### TR/MAX - COMPRESSED AIR HORN

The horns must be fixed to a flat, rigid surface (possibly metal) using the special brackets and screws supplied.

The horn must be installed in a position protected from:

- sprays of water generated by the movement of the vehicle or by washing systems.
- foreign bodies such as stones, insects, mud, snow, etc.
- excessive heat sources (above 80°).

### ATTENTION!

the horns must be installed with mouth slightly pointing downwards to avoid entering of foreign bodies such as stones, insects, mud, snow, etc.



**L.E.B. S.p.A.** | Via Antonio Pacinotti 34 – 36040 Brendola (VI)  
Tel. 0444 400668 – Fax 0444 400829  
infoleb@leb.it | [www.leb.it](http://www.leb.it)

REV. 09/21