



COMPRESSED AIR HORN

LINE TR/MAX 12V

E3 28

Technical drawing

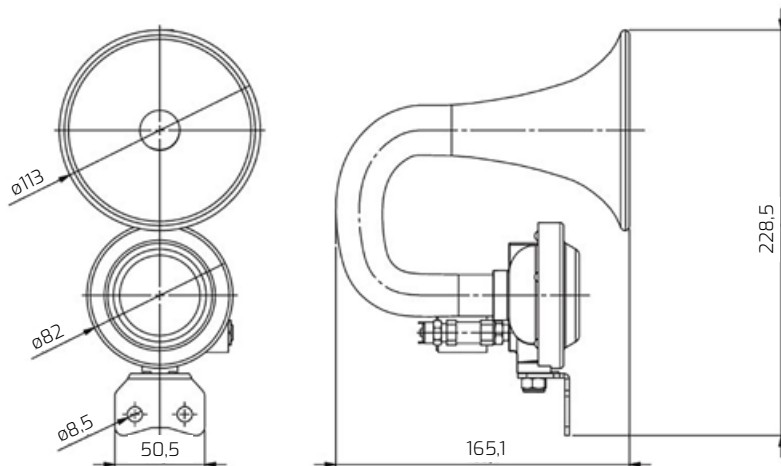

Connection

2 plugs 6,3 x 0,8 mm

LINE TR/MAX 12V

Technical features

Nominal Voltage	Vcc	12
Voltage Range	Vcc	11,4÷13,8
Current Consumption	A	<1
Operating pressure	kPa	600 ÷ 1200
Air consumption at 850 Kpa	Nl/1 min	<350
Sound Pressure Level (at 2 meters)	dB(A)	117
Fundamental frequency	Hz	400
Durability (1" On + 4" Off)	cycles	>500.000
Corrosion resistance (UNI 9227)	h	>500
Operating and Storage Temperature	°C	from -30 to +80
Vibrations (30 min x 3 axis)	g	1
Weight with screws	gr	600

Packing

Single Packing Dimensions	mm	215 x 150 x 120 h
Master Carton Quantity	pcs	10
Master Carton Dimensions	cm	52 x 38 x 26 h
Master Carton Weight	kg	7

Mounting Instructions

TR/MAX - COMPRESSED AIR HORN

The horns must be fixed to a flat, rigid surface (possibly metal) using the special brackets and screws supplied.

The horn must be installed in a position protected from:

- prays of water generated by the movement of the vehicle or by washing systems.
- foreign bodies such as stones, insects, mud, snow, etc.
- excessive heat sources (above 80°).

ATTENTION!

the horns must be installed with mounth slightly pointing downwards to avoid entering of foreign bodies such as stones, insects, mud, snow, etc.

